

4TH FLOOR PLAN

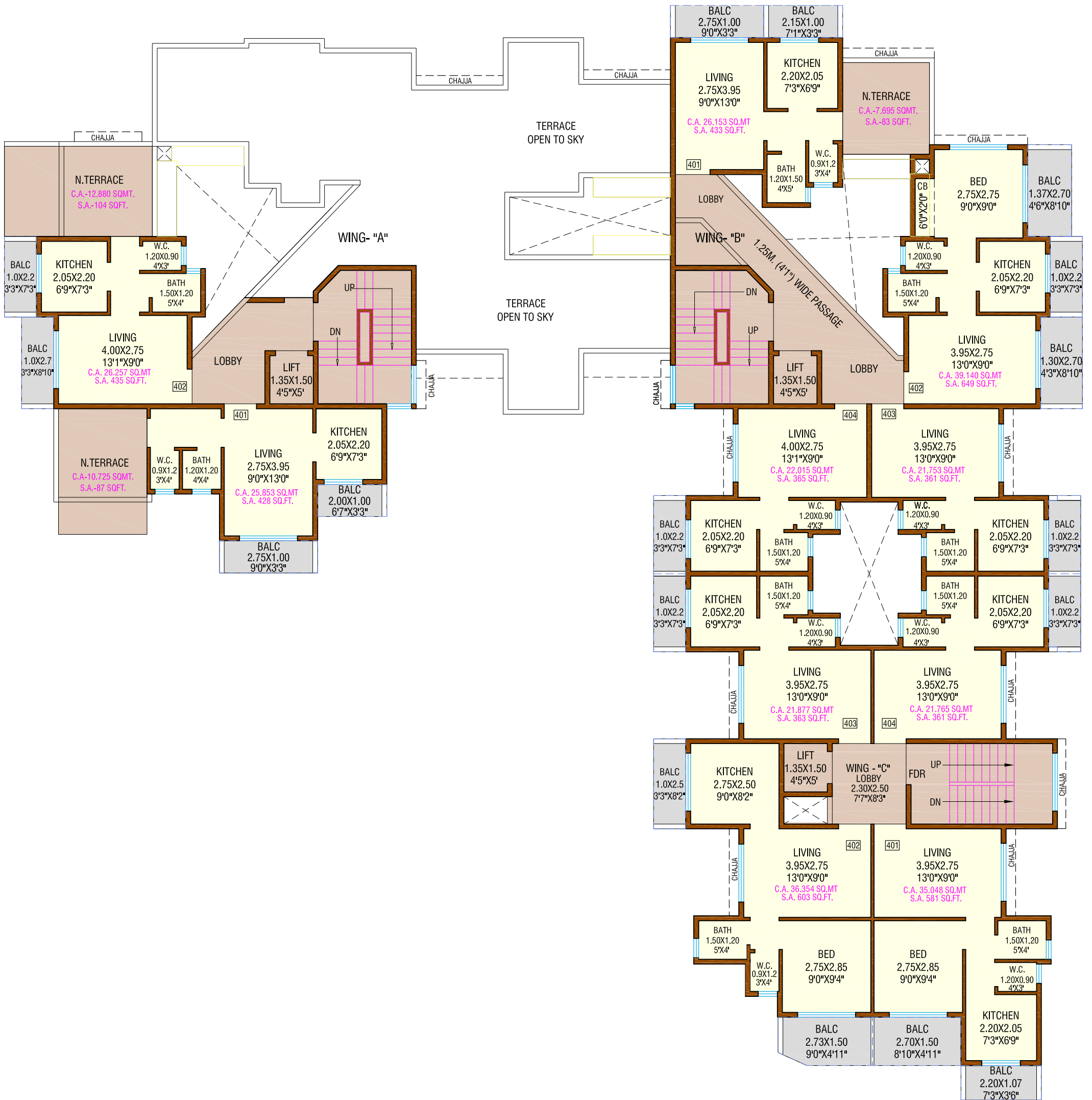

SURVEY NO-28/1(2), VILLAGE - AADAI, PANVEL



NOTE:- SUBJECT TO APPROVAL FROM CONCERNED AUTHORITY.
NOTE:- SALABLE AREA CALCULATION AS SUGGESTED BY BUILDER/DEVELOPER.

ARCHITECT