

## LOCATION MAP



Site Add: Survey No. 46/2, Kiravali, Karjat-410201

KIRAVALI, KARJAT

'The green address' of connectivity

### LOCATION ADVANTAGES

- Karjat Railway Station - 3 km
- Located in serene natural ecosystem
- At walking distance from Karjat-Neral road

A project by:

**SPACE SIDDHI HOMES**

A joint venture by:



S 29-31, Payal Complex, Sector 17, Opp. Railway Station, New Panvel-East, Navi Mumbai - 410 206, India

+91 93211 05500 SMS SPI "SHC" to 56677 contact@spaceindia.in spaceindia.in

Disclaimer: All specifications, drawings, amenities, facilities, parameters, etc., shown in this brochure are subject to change as per the approval from the respective authorities. The final decision remains with the developers.

WELCOME TO A LIFE  
'GREEN AT HEART'

**SPACE  
HILL CREST**  
K A R J A T





Artista Impression

## GREEN

The colour of renewal and rebirth

The color of growth

Green renews and restores depleted energy

Re-energizes from the stress of modern living

Restores back to a sense of well being

Green is nurture, green is peace

Green is wealth, green is prosperity

Welcome to a world

Where your life is embraced with ample of green

Welcome to

## SPACE HILL CREST

KARJAT

1 RK & 1 BHK Budget Homes

Welcome to a life

'Green at heart'





Welcome to  
a world where prosperity dwells

## SPACE HILL CREST

KARJAT

1 RK & 1 BHK Budget Homes

A residential community of 3 buildings comprising of G+4 storeys featuring 1 RK & 1 BHK budget homes at Karjat, nature's gifted region in the Raigad district.

Come to this community to rediscover your life amid the verdant hill views, mesmerizing green panoramas and the alluring nature's company. Experience a well-protected and luxurious life in the nature's company and celebrate the spirit of a life that is 'green at heart'.

### PROJECT HIGHLIGHTS-

- 3 buildings of G+4 storeys with lifts
- 1 RK & 1 BHK apartments
- Luxurious lifestyle features
- Ample open space



Artia's impression



# L layout plan







## RECREATIONAL FEATURES

### CHILDREN'S PLAY AREA

An 'amusing garden of green'

### SENIOR CITIZEN AREA

For the 'green at hearts'

### AMPHITHEATRE

Your 'private green venue'

### JOGGING TRACK

'A green lead' towards health

### MULTIPURPOSE LAWN

A lavish 'carpet of green'

### YOGA AND MEDITATION ZONE

To keep you 'green from within'

## INTERNAL SPECIFICATIONS

### FLOORING

- Designer vitrified flooring in all rooms

### KITCHEN

- Designer tiles in kitchen above platform
- Granite kitchen platform with S.S. sink

### BATHROOM

- Designer tiles in bathroom & W.C.
- Concealed plumbing with good quality C.P. fittings
- Sanitary fittings of reputed make

### DOORS AND WINDOWS

- 3/4 track aluminium sliding windows
- Attractive Laminated designer doors with good quality door fittings

### COMMON FEATURES

- Concealed copper wiring with adequate electric points
- Good quality ISI marked modular switches
- Cross-ventilated rooms

### SECURITY

- 24x7 security in the community
- Security cabin









# Floor plans



WING C, D & E  
Ground Floor Plan



WING C, D & E  
Typical Floor Plan  
(1st to 4th Floor Plan)







# Floor plans

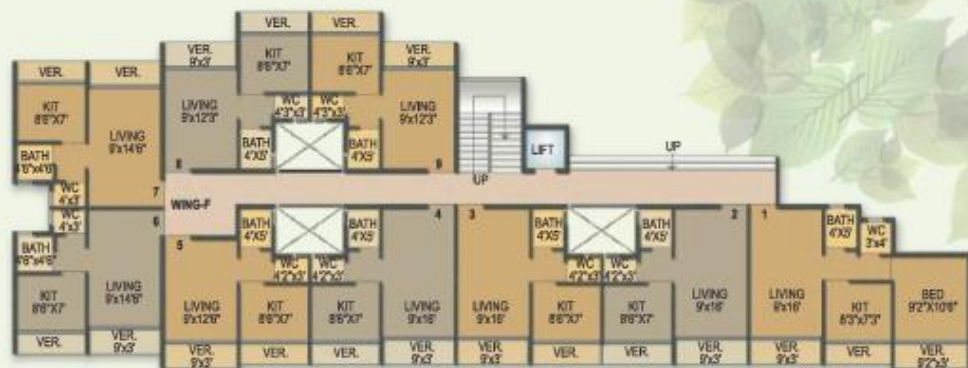

WING F  
Ground Floor Plan

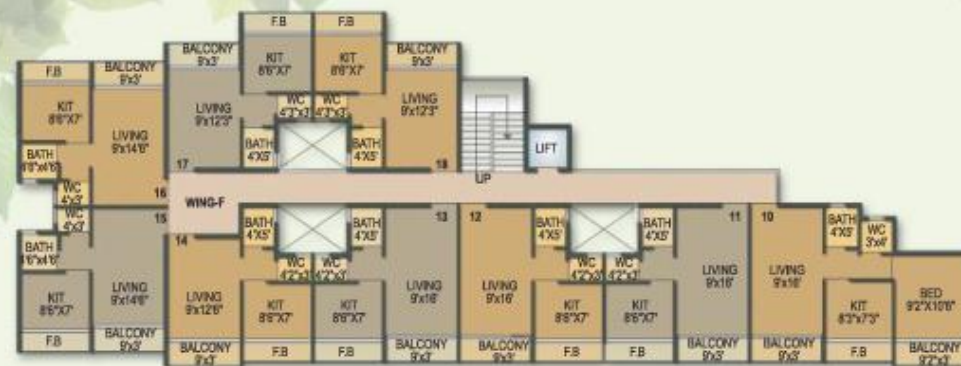

WING F  
Typical Floor Plan  
(1st to 4th Floor Plan)

